

首龍工業股份有限公司
SOW LONG INDUSTRIAL CO., LTD



公司簡介 Introduction:

我們是高品質的閥門制造商，由其球閥、閘閥、截止閥、逆止閥、Y型過濾器、調節閥、氣動閥、電動閥等。可提供多種尺寸和材質。這些閥門廣泛應用於石油、化工、電站、印染、食品、制藥、冶金、給排水系統、市政工程等行業。

1979年我們在臺灣創立第一家工廠，是一個集設計、製造、銷售、服務於一體的閥門專業製造廠商。在創立初期，公司祇是加工、裝配、銷售，鑄件是外購，年銷售量為1000噸左右。1988年公司進行了擴建，新增了設備，年銷售量達到了1500噸。

2000年，在中國大陸（廣東省中山市三鄉鎮大佈城桂工業區）投資1300萬美元，新建了一座面積約22000平方米的廠房，成立了第二個工廠，年生產力達到2200噸，年銷售量達到2000噸。

2004年，在中國大陸成立第三個工廠，投資金額1500萬美元，面積約25000平方米，年生產能力增加2000噸，年生產總能力達到4200噸以上，年銷售總量達到4000噸。

我們的產品分佈世界各地，以優越的質量贏得各界好評和信賴，業務穩定的增長，產品需求量日益增加。

同時我們公司還通過了ISO9001-2000, TRD100, CE, API6D, API607, DNV 和 CNS 正字標記等證書。

我們的目標是成為你們的最佳伙伴和供應商。我們竭盡所能提供給你完全符合要求的產品，並準時交貨，承諾提供更好的支援，以達到當今商業領域的品質標準要求。



△ 臺灣總廠 TAIWAN FACTORY



△ 廠房 FACTORY (二)



△ 廠房 FACTORY (三)

資質認證 Certificate:

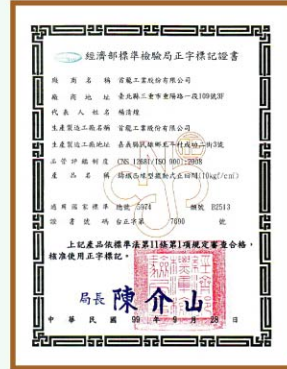
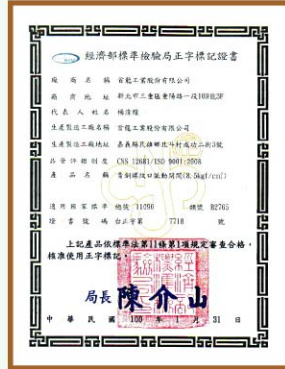
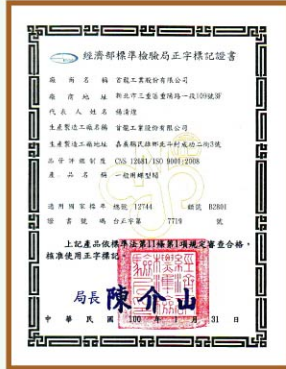
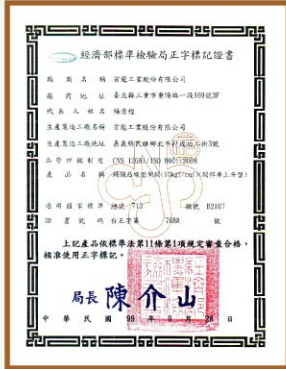
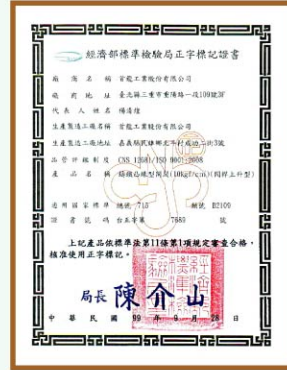
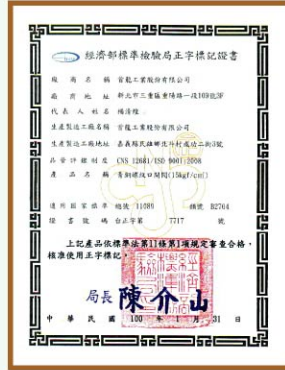
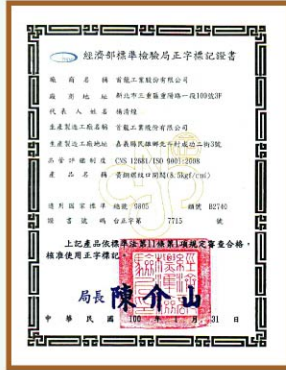
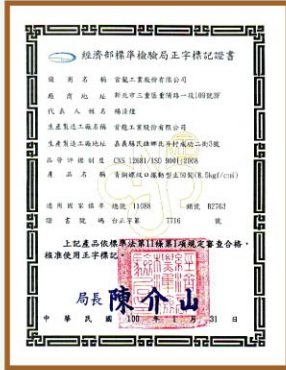

檢驗設備 Verification Set



Metallurgical Microscope
(With Digital Camera)
金相顯微鏡



Charpy Impact Testing Machine
沖擊試驗機

Universal Testing Machine
(Tensile, Yield Strength...etc)
拉伸試驗機



Spectrometer
光譜分析儀

生產流程 Production Flow Chart



Design
設計



Wax Injection
射蠟



Dipping
浸漿



Pouring
澆鑄



Dewax
脫蠟



Drying
乾燥



Shot Blasting
噴砂



CNC Lathe Machining
CNC加工



CNC Milling Machine Machining
CNC 銑床加工



Finished Product Assembly
組裝, 裝配



Ball Machining
鋼球加工



Tapping
攻牙



Pressure Testing
壓力測試



Packing Of The Final Product
成品包裝

125S/200W.O.G 砲金銅閘閥

Mode: TC313

BRONZE GATE VALVE Non-rising stem, Screwed bonnet, Solid wedge disc, Threaded end, Conform CNS 11090 B2765

台正字第7718號

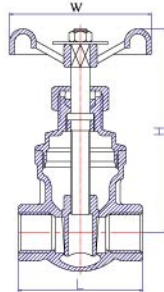

UNIT/mm

SIZE	1/2"	3/4"	1"	1 1/4"	1 1/2"	2"	2 1/2"	3"	4"
L	43	48	53	60	62	70	87	96	115
H	76	84	96	110	124	142	184	212	256
W	53	53	58	71	71	83	100	112	130

部件名稱 PART NAME	材質 MATERIAL	
	TC313	
閥體 BODY	CAST BRONZE	
閥蓋 BONNET	CAST BRONZE	
閥桿 STEM	BRASS/DZR# (抗脫鋅材質)	
閥瓣 DISC	CAST BRONZE	
螺母 NUT	BRASS	
中口 PACKING	PTFE	
手輪 HANDWHEEL	CAST IRON	

最高使用壓力 WORKING PRESSURE	試驗壓力 (水壓) TEST PRESSURE(WATER)	
	120°C以下之水、油、瓦斯 W.O.G.(UNDER 120°C)	閥體 BODY
20.0kgf/cm ²		15.0kgf/cm ²

150S/300W.O.G 砲金銅昇桿式閘閥

Mode: TC314

BRONZE GATE VALVE Rising stem, Screwed bonnet, Solid wedge disc, Threaded end, Conform to CNS 11089 B2764 & MSS SP-80

台正字第7717號

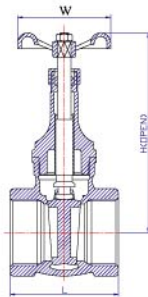

UNIT/mm

SIZE	1/2"	3/4"	1"	1 1/4"	1 1/2"	2"	2 1/2"	3"
L	48	52	62	67	75	84	104	114
H	120	149	185	210	245	290	340	400
W	54	62	71	77	92	103	118	130

部件名稱PART NAME	材質 MATERIAL	
	TC314	
閥體 BODY	CAST BRONZE	
閥蓋 BONNET	CAST BRONZE	
閥桿 STEM	DZR#(抗脫鋅材質)	
閥瓣 DISC	CAST BRONZE	
螺母 NUT	BRASS	
中口 PACKING	PTFE	
手輪 HANDWHEEL	CAST IRON	

最高使用壓力 WORKING PRESSURE	試驗壓力 (水壓) TEST PRESSURE(WATER)	
	120°C以下之水、油、瓦斯 W.O.G.(UNDER 120°C)	閥體 BODY
16.9kgf/cm ²		24.0kgf/cm ²

125S/200W.O.G 砲金銅橫式逆止閥

Mode: TC583

BRONZE SWING CHECK VALVE

Screwed cap, Swing type disc, Threaded end, Conform to CNS 11088 B2763

台正字第7716號

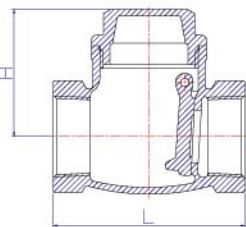

UNIT/mm

SIZE	1/2"	3/4"	1"	1 1/4"	1 1/2"	2"	2 1/2"	3"	4"
L	56	62	68	79	92	110	131	151	172
H	35	40	45	53	58	68	75	84	99

部件名稱PART NAME	材質 MATERIAL	
	TC583	
閥體 BODY	CAST BRONZE	
閥蓋 BONNET	CAST BRONZE	
閥瓣 DISC	CAST BRONZE	
塞頭 PLUG	BRASS	
銷 PIN	BRASS	

最高使用壓力 WORKING PRESSURE	試驗壓力 (水壓) TEST PRESSURE(WATER)	
	120°C以下之水、油、瓦斯 W.O.G.(UNDER 120°C)	閥體 BODY
10.0kgf/cm ²		15.0kgf/cm ²

125S/200W.O.G 砲金銅無聲逆止閥

Mode: TC584

BRONZE SILENT CHECK VALVE Bronze body and bonnet, Spring loaded lift type disc, Renewable NBR seat, Threaded ends

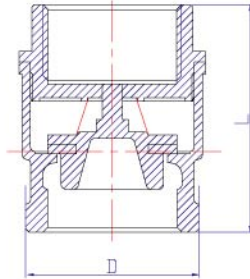

UNIT/mm

SIZE	1/2"	3/4"	1"	1 1/4"	1 1/2"	2"
L	69	82	86	92	102	126
D	35	40	48	56	64	80

部件名稱PART NAME	材質 MATERIAL
	TC584
閥體 BODY	CAST BRONZE
閥蓋 BONNET	CAST BRONZE
閥瓣 DISC	CAST BRONZE
閥座 SEAT	NBR
彈簧 SPRING	STAINLESS STEEL

最高使用壓力 WORKING PRESSURE		試驗壓力 (水壓) TEST PRESSURE (WATER)	
80°C以下之 靜流水 STILL WATER (UNDER 80°C)	80°C以下之 脈動水 UNDULATED WATER (UNDER 80°C)	閥體 BODY	閥座 SEAT
17.5 kgf/cm ²	10.0 kgf/cm ²	32 kgf/cm ²	24 kgf/cm ²

150S/600W.O.G 砲金銅球塞閥

Mode: TC153

BRONZE BALL VALVE

Standard port, Blowout-proof stem, Anti-leakage device, Threaded ends

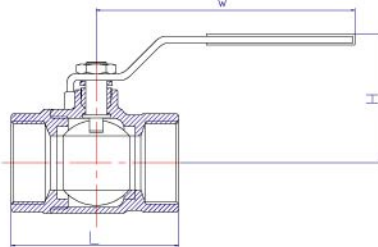

UNIT/mm

SIZE	1/4"	3/8"	1/2"	3/4"	1"	1 1/4"	1 1/2"	2"	2 1/2"	3"
L	47	47	56	64	76	85	92	110	131	150
H	33	33	35	41	50	55	61	65	83	90
W	78	78	78	100	102	136	136	148	195	195

部件名稱PART NAME	材質 MATERIAL
	TC153
閥體 BODY	CAST BRONZE
閥蓋 BONNET	CAST BRONZE
閥桿 STEM	BRASS
鋼球 BALL	BRASS / SUS304
閥座 SEAT	PTFE
把手 HANDLE	STAINLESS STEEL

最高使用壓力 WORKING PRESSURE		試驗壓力 TEST PRESSURE	
常溫之水、油、空氣 W.O.G.(NORMAL TEMPERATURE)		閥體 (水壓) BODY(WATER)	閥座 (氣壓) SEAT(AIR)
42.0 kgf/cm ²		63.0 kgf/cm ²	6.0 kgf/cm ²

150S/300W.O.G 砲金銅Y型過濾器

Mode: TC673

BRONZE Y-STRAINER

Screwed bonnet, Y-pattern body, 304 stainless steel screen

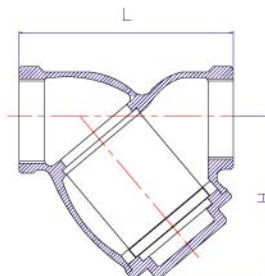

UNIT/mm

SIZE	1/2"	3/4"	1"	1 1/4"	1 1/2"	2"	2 1/2"	3"
L	80	100	115	135	160	190	229	264
H	60	70	75	90	102	128	132	146

部件名稱PART NAME	材質 MATERIAL
	TC673
閥體 BODY	CAST BRONZE
閥蓋 BONNET	CAST BRONZE
過濾網 SCREEN	STAINLESS STEEL(20MESH)
大薄片 GASKET	PTFE

最高使用壓力 WORKING PRESSURE		試驗壓力 (水壓) TEST PRESSURE (WATER)	
120°C以下之水、油、瓦斯 W.O.G.(UNDER 120°C)		閥體 BODY	
16.9kgf/cm ²		32.0kgf/cm ²	

200W.O.G 鑄黃銅閘閥

Mode:TC313B

BRASS GATE VALVE

Wedge disc, Threaded ends, Conform to CNS 9805 B2740

台正字第7715號

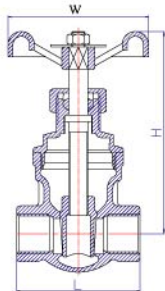

UNIT/mm

SIZE	1/4"	3/8"	1/2"	3/4"	1"	1 1/4"	1 1/2"	2"	2 1/2"	3"	4"
L	40	41	43	48	53	60	62	70	87	96	115
H	74	74	76	84	96	110	124	142	184	212	256
W	53	53	53	53	58	73	73	84	100	112	130

部件名稱 PART NAME	材質 MATERIAL	
	TC313B	
閥體 BODY	CAST BRASS	
閥蓋 BONNET	CAST BRASS	
閥桿 STEM	BRASS	
閥瓣 DISC	CAST BRASS	
螺母 NUT	BRASS	
中口 PACKING	PTFE	
手輪 HANDWHEEL	CAST IRON	

最高使用壓力 WORKING PRESSURE	試驗壓力 (水壓) TEST PRESSURE(WATER)	
120°C以下之水、油、瓦斯 W.O.G.(UNDER 120°C)	閥體 BODY	閥座 SEAT
10.0 kgf/cm ²	20.0kgf/cm ²	15.0kgf/cm ²

200W.O.G 鑄黃銅逆止閥

Mode:TC583B

BRASS SWING CHECK VALVE

Screwed cap, Swing type disc, Threaded ends, Conform to CNS 9804 B2739

台正字第7716號

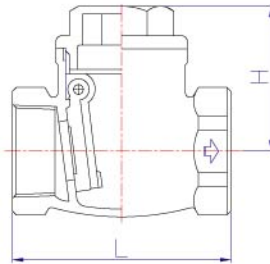

UNIT/mm

SIZE	1/2"	3/4"	1"	1 1/4"	1 1/2"	2"	2 1/2"	3"	4"
L	56	62	68	79	92	110	131	151	172
H	35	40	45	53	58	68	75	84	99

部件名稱 PART NAME	材質 MATERIAL	
	TC583B	
閥體 BODY	CAST BRASS	
閥蓋 BONNET	CAST BRASS	
閥瓣 DISC	CAST BRASS	
塞頭 PLUG	BRASS	
銷 PIN	BRASS	

最高使用壓力 WORKING PRESSURE	試驗壓力 (水壓) TEST PRESSURE(WATER)	
常溫之水、油、空氣 W.O.G.(NORMAL TEMPERATURE)	閥體 BODY	閥座 SEAT
10.0 kgf/cm ²	20.0 kgf/cm ²	15.0 kgf/cm ²

600W.O.G 鑄黃銅球塞閥

Mode: TC153B

BRASS BALL VALVE

Standard port, Blowout-proof stem, Anti-leakage device, Threaded ends

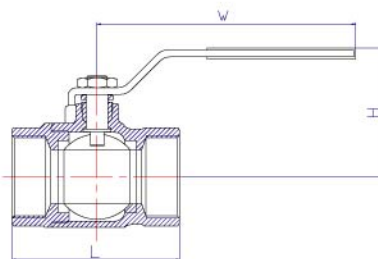

UNIT/mm

SIZE	1/4"	3/8"	1/2"	3/4"	1"	1 1/4"	1 1/2"	2"	2 1/2"	3"
L	47	47	56	64	76	85	92	110	131	150
H	33	33	35	41	50	55	61	65	83	90
W	78	78	78	100	102	136	136	148	195	195

部件名稱PART NAME	材質 MATERIAL	
	TC153B	
閥體 BODY	CAST BRASS	
閥蓋 BONNET	CAST BRASS	
閥桿 STEM	BRASS	
鋼球 BALL	BRASS / SUS304	
閥座 SEAT	PTFE	
把手 HANDLE	STAINLESS STEEL	

最高使用壓力 WORKING PRESSURE	試驗壓力 TEST PRESSURE	
常溫之水、油、空氣 W.O.G.(NORMAL TEMPERATURE)	閥體 (水壓) BODY (WATER)	閥座 (氣壓) SEAT (AIR)
42.0 kgf/cm ²	63.0 kgf/cm ²	6.0 kgf/cm ²

JIS-10K 鑄鐵非昇桿式閘閥

Mode:TC381NR

CAST IRON GATE VALVE (NON-RISING STEM)

Conform to CNS 713 B2107

台正字第7688號

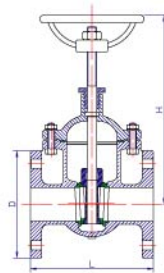

UNIT/mm

SIZE	2"	2 1/2"	3"	4"	5"	6"	8"	10"	12"
L	180	190	200	230	250	270	290	330	350
H	252	270	290	365	420	455	575	686	782
D	155	175	185	210	250	280	330	400	445

部件名稱 PART NAME	材質 MATERIAL	
	TC381NR	
閥體 BODY	CAST IRON (FC20)	
閥蓋 BONNET	CAST IRON (FC20)	
閥桿 STEM	STAINLESS STEEL (SUS410)	
閥瓣 DISC	CAST IRON (FC20)	
閥座環 SEAT RING	BRONZE/SUS304	
牛楠 GLAND	DUCTILE IRON (FCD45)	
中口 PACKING	ASBESTOS	
手輪 HANDWHEEL	CAST IRON (FC20)	

測試 TEST:	
工作壓力 WORKING PRESSURE	10K
閥體壓力 BODY PRESSURE	21.1 kgf/cm ²
閥座壓力 SEAT PRESSURE	15.0 kgf/cm ²

JIS-10K 鑄鐵昇桿式閘閥

Mode:TC381R

CAST IRON GATE VALVE (RISING STEM)

Conform to CNS 715 B2109

台正字第7689號

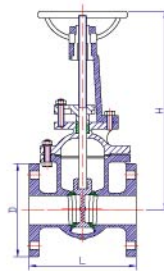

UNIT/mm

SIZE	2"	2 1/2"	3"	4"	5"	6"	8"	10"	12"
L	180	190	200	230	250	270	290	330	350
H	267	280	300	405	460	560	705	880	1100
D	155	175	185	210	250	280	330	400	445

部件名稱 PART NAME	材質 MATERIAL	
	TC381R	
閥體 BODY	CAST IRON (FC20)	
閥蓋 BONNET	CAST IRON (FC20)	
閥桿 STEM	STAINLESS STEEL (SUS410)	
閥瓣 DISC	CAST IRON (FC20)	
閥座環 SEAT RING	BRONZE/SUS304	
牛楠 GLAND	DUCTILE IRON (FCD45)	
中口 PACKING	ASBESTOS	
手輪 HANDWHEEL	CAST IRON (FC20)	

測試 TEST:	
工作壓力 WORKING PRESSURE	10K
閥體壓力 BODY PRESSURE	21.1 kgf/cm ²
閥座壓力 SEAT PRESSURE	15.0 kgf/cm ²

JIS-10K 鑄鐵橫式逆止閥

Mode:TC591

CAST IRON SWING CHECK VALVE

Conform to CNS 5974 B2513

台正字第7690號

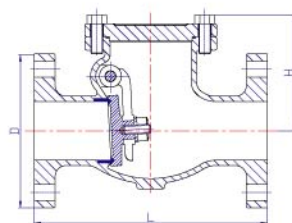

UNIT/mm

SIZE	2"	2 1/2"	3"	4"	5"	6"	8"	10"	12"
L	203	216	241	292	330	356	495	622	698
H	105	115	140	155	170	203	246	288	342
D	155	175	185	210	250	280	330	400	445

部件名稱 PART NAME	材質 MATERIAL	
	TC591	
閥體 BODY	CAST IRON (FC20)	
閥蓋 BONNET	CAST IRON (FC20)	
閥瓣 DISC	CAST IRON (FC20)	
閥座環 SEAT RING	BRONZE/SUS304	
橫銷 HINGE PIN	STAINLESS STEEL(SUS304)	
塞頭 PLUG	CARBON STEEL (SCS41)	

測試 TEST:	
工作壓力 WORKING PRESSURE	10K
閥體壓力 BODY PRESSURE	21.1 kgf/cm ²
閥座壓力 SEAT PRESSURE	15.0 kgf/cm ²

JIS-10K 鑄鐵中型式逆止閥

Mode: TC591Z

CAST IRON SWING CHECK VALVE

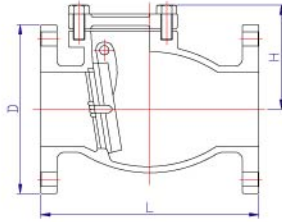

UNIT/mm

SIZE	50	65	80	100	125	150	200
L	150	165	175	219	242	288	362
H	80	88	100	120	135	150	207
D	155	175	185	210	250	280	330

部件名稱 PART NAME	材質 MATERIAL
	TC591Z
閥體 BODY	CAST IRON (FC20)
閥蓋 BONNET	CAST IRON (FC20)
閥瓣 DISC	CAST IRON(FC20)
閥座迫緊 DISC SEAT	NBR
閥座 SEAT	CAST BRONZE/SUS304
銷 PIN	STAINLESS STEEL
塞頭 PLUG	CARBON STEEL (SUS41)

測試 TEST:	
工作壓力 WORKING PRESSURE	10K
閥體壓力 BODY PRESSURE	21.1 kgf/cm ²
閥座壓力 SEAT PRESSURE	15.0 kgf/cm ²

JIS-10K 鑄鐵雙瓣式逆止閥

Mode: TC586

CAST IRON WAFER TYPE CHECK VALVE

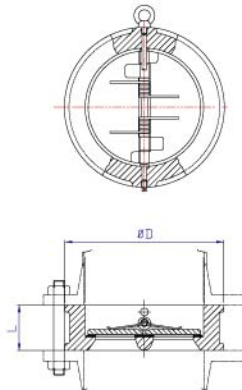

UNIT/mm

SIZE	2"	2 1/2"	3"	4"	5"	6"	8"	10"	12"
L	43	46	64	64	70	76	89	114	114
D	101	121	131	156	187	217	267	330	375

部件名稱PART NAME	材質 MATERIAL
	TC586
閥體 BODY	FC
板 PLATE	SUS304
定位銷 STOP PIN	SUS304
閥桿 STEM	SUS304
彈簧 SPRING	SUS304
閥座 SEAT (Full-Lier)	EPDM

最高使用壓力 WORKING PRESSURE		試驗壓力(水壓) TEST PRESSURE(WATER)	
80°C以下之靜流水 STILL WATER (UNDER 80°C)	80°C以下之脈動水 UNDULATED WATER (UNDER 80°C)	閥體 BODY	閥座 SEAT
14.0 kgf/cm ²	10.0 kgf/cm ²	21.1 kgf/cm ²	15.0 kgf/cm ²

JIS-10K 鑄鐵無聲逆止閥

Mode: TC514

CAST IRON SILENT CHECK VALVE

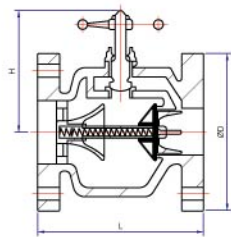

UNIT/mm

SIZE	2"	2 1/2"	3"	4"	5"	6"	8"	10"	12"
L	187	200	210	218	255	279	415	555	615
H	163	173	180	190	210	225	245	285	310
D	155	175	185	210	250	280	330	400	445

部件名稱 PART NAME	材質 MATERIAL
	TC514
閥體 BODY	CAST IRON(FC20)
閥蓋 BONNET	BRONZE BC6
彈簧 SPRING	STAINLESS STEEL(SUS304)
閥瓣 DISC	NBR
閥桿螺母 STEM NUT	BRASS

測試 TEST:	
工作壓力 WORKING PRESSURE	10K
閥體壓力 BODY PRESSURE	21.1 kgf/cm ²
閥座壓力 SEAT PRESSURE	15.0 kgf/cm ²

JIS-10K 鑄鐵球型閥

Mode: TC481

CAST IRON GLOBE VALVE

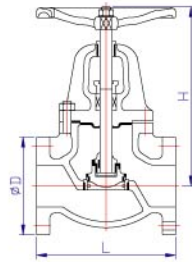

UNIT/mm

SIZE	2"	2 1/2"	3"	4"	5"	6"	8"	10"	12"
L	200	220	240	290	360	410	500	620	700
H	277	307	353	404	454	533	642	665	755
D	155	175	185	210	250	280	330	400	445

部件名稱 PART NAME	材質 MATERIAL	
	TC481	
閥體 BODY	CAST IRON (FC20)	
閥蓋 BONNET	CAST IRON (FC20)	
閥桿 STEM	STAINLESS STEEL (SUS410)	
閥瓣 DISC	CAST IRON (FC20)	
閥座環 SEAT RING	BRONZE/SUS304	
牛楠 GLAND	DUCTILE IRON (FC20)	
中口 PACKING	ASBESTOS	
手輪 HANDWHEEL	CAST IRON (FC20)	

測試 TEST:	
工作壓力 WORKING PRESSURE	10K
閥體壓力 BODY PRESSURE	21.1 kgf/cm ²
閥座壓力 SEAT PRESSURE	15.0 kgf/cm ²

JIS-10K 鑄鐵Y型過濾器

Mode: TC681

CAST IRON Y -STRAINER

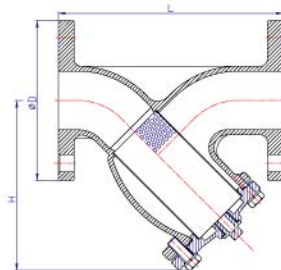

UNIT/mm

SIZE	2"	2 1/2"	3"	4"	5"	6"	8"	10"	12"
L	250	285	315	370	420	490	570	680	800
H	155	190	200	232	274	326	397	512	562
D	155	175	185	210	250	280	330	400	445

部件名稱 PART NAME	材質 MATERIAL	
	TC681	
閥體 BODY	CAST IRON (FC20)	
閥蓋 BONNET	CAST IRON (FC20)	
過濾器 SCREEN	STAINLESS STEEL (SUS304)	
塞頭 PLUG	CAST IRON (SUS41)	
大薄片 GASKET	ASBESTOS	

測試 TEST:	
工作壓力 WORKING PRESSURE	10K
閥體壓力 BODY PRESSURE	21.1 kgf/cm ²

JIS-10K 鑄鐵拉柄式底閥

Mode: TC521F

CAST IRON FULL FLOW FOOT VALVE

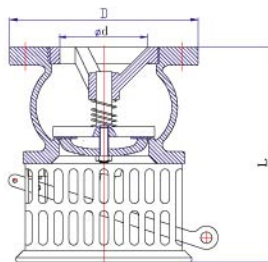

UNIT/mm

SIZE	2"	2 1/2"	3"	4"	5"	6"	8"
d	50	65	80	100	125	150	200
L	190	200	220	240	260	280	390
D	155	175	185	210	250	280	330

部件名稱 PART NAME	材質 MATERIAL	
	TC521F	
閥體 BODY	CAST IRON(FC20)	
閥瓣 DISC	CAST BRASS(YBSC3)	
閥座 SEAT	CAST BRASS(YBSC3)	
閥座環 SEAT RING	EPDM	
閥桿 STEM	BRASS(B16)	
手柄 LEVER HANDLE	CAST IRON(FC20)	
過濾網 SCREEN	STAINLESS STEEL (SUS304)	
底盤 PLATE	CAST IRON(FC20)	

最高使用壓力 WORKING PRESSURE	試驗壓力(水壓) TEST PRESSURE(WATER)	
常溫之脈動水 UNDULATED WATER (NORMAL TEMPERATURE)	閥體 BODY	閥座 SEAT
10.0 kgf/cm ²	21.1 kgf/cm ²	15.0 kgf/cm ²

JIS-10K/ANSI-150LB

鑄鐵對夾式 把手蝶型閥
鑄鐵對夾式 齒輪蝶型閥

Mode: TC720/TC721
TC720G/TC721G

**FC20 /FCD45 BUTTERFLY VALVE & LEVER &
FC20 /FCD45 BUTTERFLY VALVE & GEAR**

Conform CNS 12744 B2801

台正字第7719號

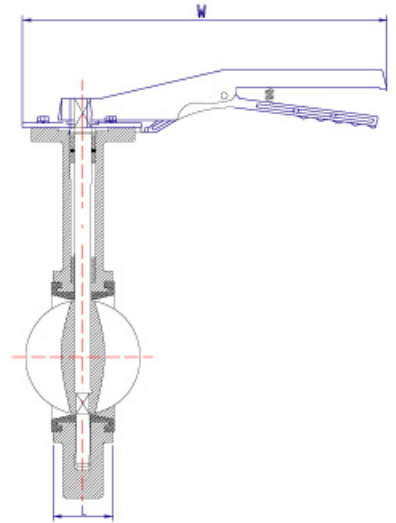
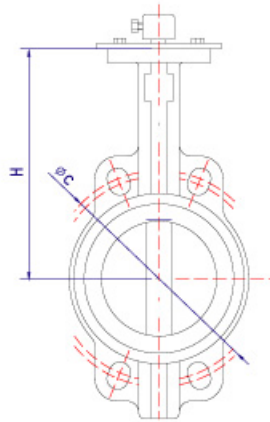

部件名稱 PART NAME	材質 MATERIAL
閥體 BODY	FC20
閥瓣 DISC	FCD45 / CF8
閥座 SEAT	EPDM
閥桿 STEM	SS410
襯套 BUSHING	PTFE
O-型圈 O-RING	EPDM
指示盤 INDICATOR	CARBON STEEL
手柄 LEVER	CAST IRON
螺栓 BOLT	CARBON STEEL
齒輪箱 GEAR	DUCTILE IRON

把手式蝶型閥LEVER TYPE JIS-10K/ANSI-150LB(FC20/FC45): TC720
齒輪式蝶型閥GEAR TYPE JIS-10K/ANSI-150LB(FC20/FC45): TC720G
把手式蝶型閥LEVER TYPE JIS-10K/ANSI-150LB(FC20/304): TC721
齒輪式蝶型閥GEAR TYPE JIS-10K/ANSI-150LB(FC20/304): TC721G

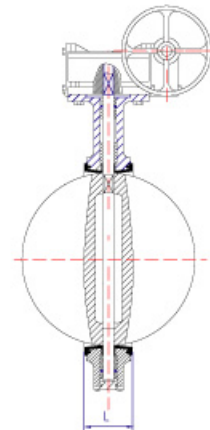
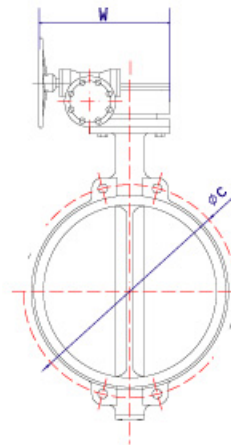

UNIT/mm

SIZE	C(10K)	C(150LB)	L	W	H
2"	120	120.6	42	207	140
2 1/2"	140	139.7	44.7	207	150
3"	150	152.4	45.2	207	158
4"	175	190.5	52	263	176
5"	210	215.9	54.4	263	190
6"	240	241.3	55.8	263	201
8"	290	298.4	60.6	330	248
10"	355	361.9	65.6	330	276
12"	400	431.8	76.9	330	305
14"	445	476.5	75.5	434.2	368
16"	510	539.5	102	426	400
18"	565	578.0	114	426	422
20"	620	635.0	127	426	480
24"	730	749.5	151	442	562

最高使用壓力 WORKING PRESSURE	試驗壓力 TEST PRESSURE	
90°C以下之靜流水 STILL WATER (UNDER 90°C)	閥體 BODY	閥座 SEAT
10.0 kgf/cm ²	15.0 kgf/cm ²	11.0 kgf/cm ²

JIS-10K/ANSI-150LB

鑄鐵全耳式 把手蝶型閥
鑄鐵全耳式 齒輪蝶型閥

Mode: TC740/TC741
TC740G/TC741G

FC20/FCD45 BUTTERFLY VALVE & LEVER &
FC20/FCD45 BUTTERFLY VALVE & GEAR

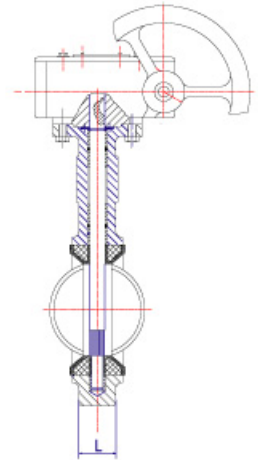
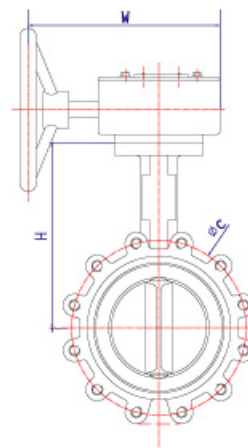
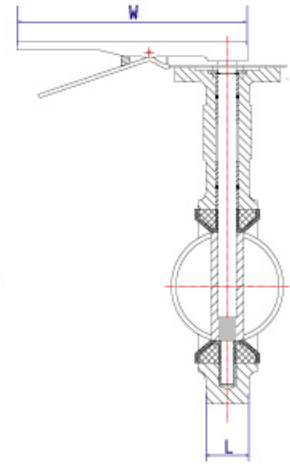
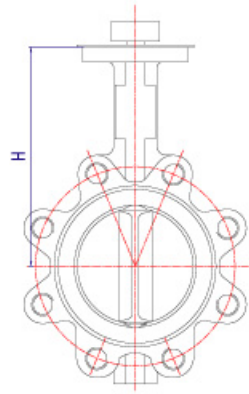

鑄鐵系列

部件名稱 PART NAME	材質 MATERIAL
閥體 BODY	FC20
閥瓣 DISC	FCD45 / CF8
閥座 SEAT	EPDM
閥桿 STEM	SS410
襯套 BUSHING	PTFE
O-型圈 O-RING	NBR
固定板 RETAINER PLATE	STEEL
螺絲 SCREW	STEEL
手柄 LEVER	CAST IRON
齒輪箱 GEAR	DUCTILE IRON

把手式蝶型閥LEVER TYPE JIS-10K/ANSI-150LB(FC20/FC45): TC740
齒輪式蝶型閥GEAR TYPE JIS-10K/ANSI-150LB(FC20/FC45): TC740G
把手式蝶型閥LEVER TYPE JIS-10K/ANSI-150LB(FC20/304): TC741
齒輪式蝶型閥GEAR TYPE JIS-10K/ANSI-150LB(FC20/304): TC741G

UNIT/mm

SIZE	C(10K)	C(150LB)	L	W	H
2 1/2"	140	139.7	49	259	155.4
3"	150	152.4	49	259	161.8
4"	175	190.5	54	259	177
5"	210	215.9	54.4	259	189.5
6"	240	241.3	58	259	205.2
8"	290	298.4	60	302	236
10"	355	261.9	67	313	266
12"	400	431.8	75.5	307	307
14"	445	476.3	75.5	307	368
16"	510	539.5	102	283	400
18"	565	578	114	283	422
20"	620	635	127	346.5	480
24"	730	749.5	151	346.5	562

最高使用壓力 WORKING PRESSURE	試驗壓力 TEST PRESSURE	
90°C 以下之靜流水 STILL WATER (UNDER 90°C)	閥體 BODY	閥座 SEAT
10.0 kgf/cm ²	15.0 kgf/cm ²	11.0 kgf/cm ²

JIS-16K 球墨鑄鐵昇桿式閘閥

Mode: TC382R

DUCTILE IRON GATE VALVE Outside screw & yoke
Rising stem, Solid wedge disc, Renewable seat rings, Flanged ends

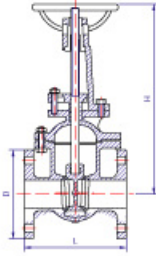

UNIT/mm

SIZE	2"	2 1/2"	3"	4"	5"	6"	8"	10"	12"
L	180	190	200	230	250	270	290	330	350
H	267	280	300	405	460	560	705	880	1100
D	155	175	200	225	270	305	350	430	480

部件名稱PART NAME	材質 MATERIAL
	TC382R
閥體 BODY	DUCTILE IRON(FCD45)
閥蓋 BONNET	DUCTILE IRON(FCD45)
閥瓣 DISC	DUCTILE IRON
閥座環 SEAT RING	STAINLESS STEEL(SUS304)
閥桿 STEM	STAINLESS STEEL(SUS304)
中口 PACKING	ASBESTOS
手輪 HANDWHEEL	CAST IRON (FC20)

最高使用壓力 WORKING PRESSURE		試驗壓力 (水壓) TEST PRESSURE(WATER)	
120°C以下之 靜流水 STILL WATER (UNDER 120°C)	220°C以下之脈 動水、油、空氣 AIR, OIL, UNDULATED WATER(UNDER 220°C)	閥體 BODY	閥座 SEAT
22.0 kgf/cm ²	16.0 kgf/cm ²	35.0 kgf/cm ²	25.0 kgf/cm ²

JIS-16K 球墨鑄鐵橫式逆止閥

Mode: TC592

DUCTILE IRON SWING CHECK VALVE
Bolted cover, Swing type disc, Renewable seat rings, Flanged ends

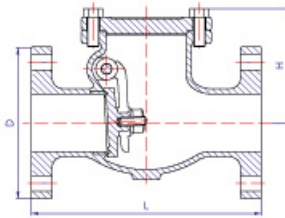

UNIT/mm

SIZE	2"	2 1/2"	3"	4"	5"	6"	8"	10"	12"
L	203	216	241	292	330	356	495	622	698
H	105	115	140	155	170	203	246	288	342
D	155	175	200	225	270	305	350	430	480

部件名稱PART NAME	材質 MATERIAL
	TC592
閥體 BODY	DUCTILE IRON(FCD45)
閥蓋 BONNET	DUCTILE IRON(FCD45)
閥瓣 DISC	DUCTILE IRON
閥座環 SEAT RING	STAINLESS STEEL(SUS304)
塞頭 PLUG	STEEL(SCS41)
銷 PIN	STAINLESS STEEL(SUS410)
大薄片 GASKET	ASBESTOS

最高使用壓力 WORKING PRESSURE		試驗壓力 (水壓) TEST PRESSURE(WATER)	
120°C以下之 靜流水 STILL WATER (UNDER 120°C)	220°C以下之脈 動水 UNDULATED WATER (UNDER 220°C)	閥體 BODY	閥座 SEAT
22.0 kgf/cm ²	16.0 kgf/cm ²	35.0 kgf/cm ²	25.0 kgf/cm ²

JIS-16K 球墨鑄鐵雙瓣式逆止閥

Mode: TC587

DUCTILE IRON WAFER TYPE CHECK VALVE
Wafer Style, Rubber seat, Spring actuated

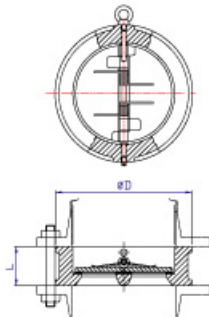

UNIT/mm

SIZE	2"	2 1/2"	3"	4"	5"	6"	8"	10"	12"
L	43	46	64	64	70	76	89	114	114
D	101	121	131	156	187	217	267	330	375

部件名稱PART NAME	材質 MATERIAL
	TC586
閥體 BODY	FC
板 PLATE	SUS304
定位銷 STOP PIN	SUS304
閥桿 STEM	SUS304
彈簧 SPRING	SUS304
閥座 SEAT (Full-Lier)	EPDM

最高使用壓力 WORKING PRESSURE		試驗壓力 (水壓) TEST PRESSURE(WATER)	
90°C以下之脈動水 UNDULATED WATER (UNDER 90°C)		閥體 BODY	閥座 SEAT
16.0 kgf/cm ²		24.0 kgf/cm ²	18.0 kgf/cm ²

JIS-16K 球墨鑄鐵無聲逆止閥

Mode: TC596

DUCTILE IRON SILENT CHECK VALVE

Renewable body & disc seat ring, Umbrella buffer prevention water hammer

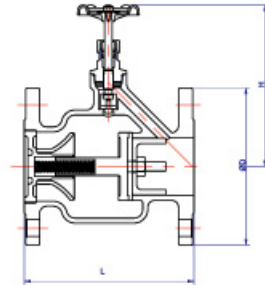

UNIT/mm

SIZE	2"	2 1/2"	3"	4"	5"	6"	8"	10"	12"
L	183	200	210	217	255	280	415	560	620
H	130	135	140	155	180	190	215	243	262
D	155	175	200	225	270	305	350	430	480

部件名稱PART NAME	材質 MATERIAL	
	TC596	
閥體 BODY	DUCTILE IRON(FCD45)	
閥蓋 BONNET	CAST BRONZE	
閥瓣 DISC	DUCTILE IRON(FCD45)	
閥桿 STEM	BRASS	
傘型緩沖器 UMBRELLA BUFFER	DUCTILE IRON(FCD45)	
導座 GUIDE	CAST BRONZE	
閥座環 SEAT RING	NBR	

最高使用壓力 WORKING PRESSURE		試驗壓力 (水壓) TEST PRESSURE(WATER)	
80℃ 以下之靜流水 STILL WATER (UNDER 80℃)	80℃ 以下之脈動水 UNULATED WATER (UNDER 80℃)	閥體 BODY	閥座 SEAT
22.0 kgf/cm ²	16.0 kgf/cm ²	35.0 kgf/cm ²	25.0 kgf/cm ²

JIS-16K 球墨鑄鐵球型閥

Mode: TC482

DUCTILE IRON GLOBE VALVE

Bolted yoke-bonnet, Swivel disc, Renewable seat rings, Flanged ends

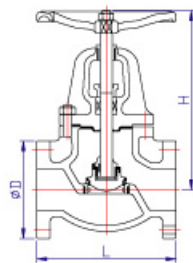

UNIT/mm

SIZE	2"	2 1/2"	3"	4"	5"	6"	8"
L	203	216	241	292	356	406	495
H	280	316	330	384	435	485	525
D	155	175	200	225	270	305	350

部件名稱PART NAME	材質 MATERIAL	
	TC482	
閥體 BODY	DUCTILE IRON(FCD45)	
閥蓋 BONNET	DUCTILE IRON(FCD45)	
閥桿 STEM	STAINLESS STEEL(SUS304)	
閥瓣 DISC	DUCTILE IRON	
閥座 SEAT	STAINLESS STEEL(SCS13)	
中口 PACKING	ASBESTOS	
手輪 HANDWHEEL	CAST IRON(FC20)	

最高使用壓力 WORKING PRESSURE		試驗壓力 (水壓) TEST PRESSURE(WATER)	
120℃ 以下之靜流水 STILL WATER (UNDER 120℃)	220℃ 以下之脈動水、油、空氣 AIR, OIL, UNULATED WATER(UNDER 220℃)	閥體 BODY	閥座 SEAT
22.0 kgf/cm ²	16.0 kgf/cm ²	35.0 kgf/cm ²	25.0 kgf/cm ²

JIS-16K 球墨鑄鐵Y型過濾器

Mode: TC682

DUCTILE IRON Y-STRAINER Bolted cover, Y-pattern body, Punched stainless steel plate screen, Flanged ends

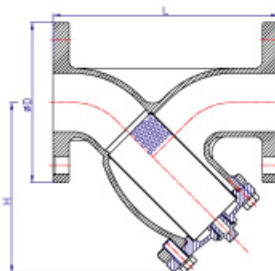

UNIT/mm

SIZE	2"	2 1/2"	3"	4"	5"	6"	8"	10"	12"
L	250	285	315	370	420	490	570	680	800
H	155	190	200	232	274	326	397	512	562
D	155	175	200	225	270	305	350	430	480

部件名稱PART NAME	材質 MATERIAL	
	TC682	
閥體 BODY	DUCTILE IRON(FCD45)	
閥蓋 BONNET	DUCTILE IRON(FCD45)	
過濾網 SCREEN	STAINLESS STEEL(SUS304)	
大薄片 GASKET	ASBESTOS	
塞頭 PLUG	DUCTILE IRON(FCD45)	

最高使用壓力 WORKING PRESSURE		試驗壓力 (水壓) TEST PRESSURE(WATER)	
120℃ 以下之靜流水 STILL WATER (UNDER 120℃)	220℃ 以下之脈動水、油、空氣 AIR, OIL, UNULATED WATER(UNDER 220℃)	閥體 BODY	
22.0 kgf/cm ²	16.0 kgf/cm ²	35.0 kgf/cm ²	

JIS-16K/PN16

球墨鑄鐵對夾式 把手式蝶型閥
球墨鑄鐵對夾式 齒輪式蝶型閥

Mode: TC722

DUCTILE IRON BUTTERFLY VALVE & LEVER &
DUCTILE IRON BUTTERFLY VALVE & GEAR

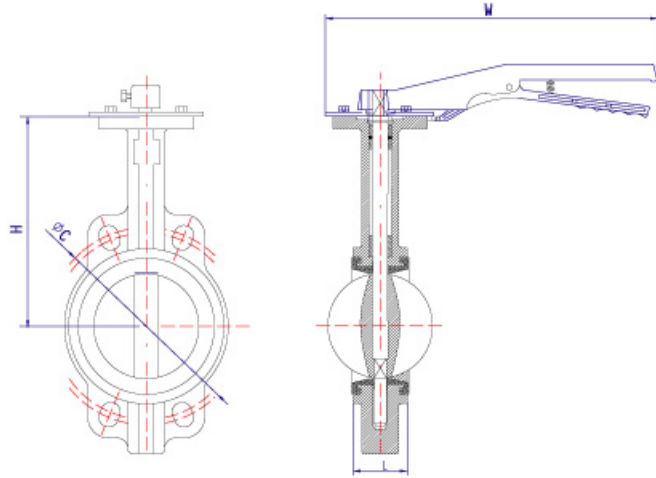

部件名稱 PART NAME	材質 MATERIAL
	TC722
閥體 BODY	DUCTILE IRON(FCD45)
閥瓣 DISC	FCD45 / CF8
閥座 SEAT	EPDM
閥桿 STEM	SS410
襯套 BUSHING	PTFE
O-型圈 O-RING	EPDM
指示盤 INDICATOR	CARBON STEEL
手柄 LEVER	CAST IRON
螺栓 BOLT	CARBON STEEL
齒輪箱 GEAR	DUCTILE IRON

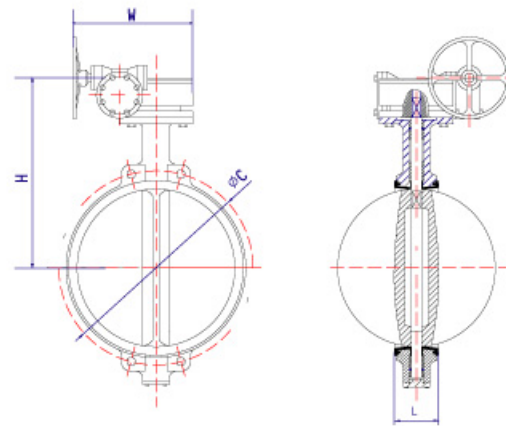

UNIT/mm

SIZE	C(16K)	C(PN16)	L	W	H
2"	120	125	42	207	140
2 1/2"	140	145	44.7	207	150
3"	160	160	45.2	207	158
4"	185	180	52	263	176
5"	225	210	54.4	263	190
6"	260	240	55.8	263	201
8"	305	295	60.6	330	248
10"	380	355	65.6	330	276
12"	430	410	76.9	330	305
14"	480	470	75.5	434.2	368
16"	540	525	102	426	400
18"	605	585	114	426	422
20"	660	650	127	426	480
24"	770	770	151	442	562

最高使用壓力 WORKING PRESSURE	試驗壓力 TEST PRESSURE	
90°C以下之油、脈動水 OIL、UNDULATED WATER (UNDER 90°C)	閥體 BODY	閥座 SEAT
16.0 kgf/cm ²	24.0 kgf/cm ²	17.6 kgf/cm ²

1000W.O.G 不銹鋼一片式牙口球塞閥

Mode: TC112

ONE-PIECE BALL VALVE SCREWED END

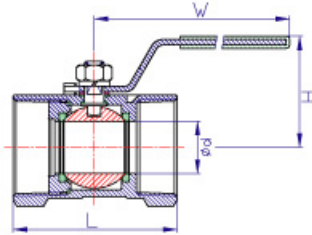

部件名稱PART NAME	材質 MATERIAL
閥體 BODY	CF8M
閥蓋 BONNET	CF8M
閥桿 STEM	SUS316
鋼球 BALL	CF8M
閥座 SEAT	PTFE
把手 HANDLE	SUS304

UNIT/mm

SIZE	1/4"	3/8"	1/2"	3/4"	1"	1 1/4"	1 1/2"	2"
d	5	7	10	13	16	20	25	32
L	39	44	59	60	72	77	84	100
H	34	38	41	45	52	57	62	68
W	69	83	96	96	116	116	158	158

閥體 (水壓) BODY(WATER)		105 kgf/cm ²
閥座 SEAT	水壓WATER	80 kgf/cm ²
	氣壓AIR	6.0 kgf/cm ²

1000W.O.G 不銹鋼一片式牙口球塞閥+蝶型把手

Mode: TC112

ONE-PIECE BALL VALVE SCREWED END

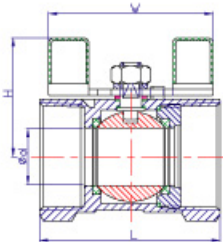

UNIT/mm

SIZE	1/4"	3/8"	1/2"	3/4"	1"	1 1/4"	1 1/2"	2"
d	5	7	10	13	16	20	25	32
L	39	44	59	60	72	77	84	100
H	26.5	28.5	32	35.5	50	57.5	61.5	67.5
W	51	55	57	57	71	71	94.5	94.5

部件名稱PART NAME	材質 MATERIAL
閥體 BODY	CF8M
閥蓋 BONNET	CF8M
鋼球 BALL	CF8M
閥座 SEAT	PTFE
閥桿 STEM	SUS316
大薄片 GASKET	PTFE
小薄片 THRUST WASHER	PTFE
中口 PACKING	PTFE
軸心螺母 STEM NUT	SUS304
彈簧華司 SPRING WASHER	SUS304
中口墊片 PAKING RING	SUS304
把手 HANDLE	SUS304

閥體 (水壓) BODY(WATER)		105 kgf/cm ²
閥座 SEAT	水壓WATER	80 kgf/cm ²
	氣壓AIR	6.0 kgf/cm ²

1000W.O.G 不銹鋼二片式牙口球塞閥

Mode: TC125

TWO-PIECE BALL VALVE SCREWED END

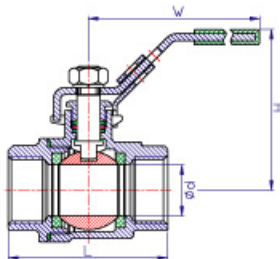

UNIT/mm

SIZE	1/4"	3/8"	1/2"	3/4"	1"	1 1/4"	1 1/2"	2"	2 1/2"	3"
d	11.6	12.7	15	20	25	32	40	50	65	80
L	52	52	58	67	78	90	104	127	158	187
H	56	56	65	68	79	84	93	99	136	146
W	102	102	123	123	153	153	183	183	246	246

部件名稱PART NAME	材質 MATERIAL
閥體 BODY	CF8M
閥蓋 BONNET	CF8M
閥桿 STEM	SUS316
鋼球 BALL	CF8M
閥座 SEAT	PTFE
把手 HANDLE	SUS304

閥體 (水壓) BODY(WATER)		105 kgf/cm ²
閥座 SEAT	水壓WATER	80 kgf/cm ²
	氣壓AIR	6.0 kgf/cm ²

1000W.O.G 不銹鋼三片式牙口/套焊口球塞閥

THREE-PIECE BALL VALVE SCREWED END / SOCKET WELD END

Mode: TC131, TC134, TC134, TC136

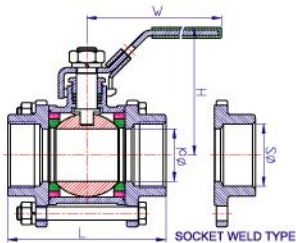

UNIT/mm

SIZE	1/4"	3/8"	1/2"	3/4"	1"	1 1/4"	1 1/2"	2"	2 1/2"	3"	4"
d	11.6	12.7	15	20	25	32	38	50	65	80	100
L	58	58	63	73	85	96	114	134	180	200	228
H	56	56	65	67	79	84	92	99	136	146	168
W	102	102	123	123	153	153	183	183	246	246	503
S	14.1	17.6	21.7	27.1	33.8	42.6	48.7	61.1	76.9	89.8	115.5

部件名稱PART NAME	材質 MATERIAL	
		TC133
閥體 BODY	CF8M	
閥蓋 BONNET	CF8M	
閥桿 STEM	SUS316	
鋼球 BALL	CF8M	
閥座 SEAT	PTFE	
把手 HANDLE	SUS304	

*牙口SCREWED END: TC131, TC133
套焊口SOCKET WELD END: TC134, TC136

閥體 (水壓) BODY(WATER)		105 kgf/cm ²
閥座 SEAT	水壓WATER	80 kgf/cm ²
	氣壓AIR	6.0 kgf/cm ²

1000W.O.G 不銹鋼三片式加長對焊口球塞閥

FULL PORT THREE-PIECE BALL VALVE EXTENDED BUTT WELD END

Mode: TC153D

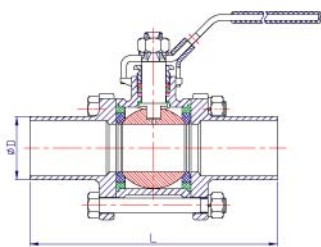

UNIT/mm

SIZE	3/8"	1/2"	3/4"	1"	1 1/4"	1 1/2"	2"	2 1/2"	3"	4"
ΦB(Sch.5)	14.9	18.4	23.9	30.7	39.4	45.3	57.2	72.1	84.9	110.1
ΦB(Sch.10)	14	17.5	23	28.4	37.1	43	54.9	70.3	83.1	108.3
ΦD	12.7	15	20	25	32	38	50	65	80	100
L	120	171	178	212	220	229	245	264	291	317

部件名稱PART NAME	材質 MATERIAL	
		TC153D
閥體 BODY	CF8M	
閥蓋 BONNET	CF8M	
鋼球 BALL	CF8M	
閥座 SEAT	PTFE	
閥桿 STEM	SUS316	
中口 PACKING	PTFE	
軸帽 GLAND	SUS304	
螺母 NUT	SUS304	
把手 HANDLE	SUS304	

閥體 (水壓) BODY(WATER)		105 kgf/cm ²
閥座 SEAT	水壓WATER	80 kgf/cm ²
	氣壓AIR	6.0 kgf/cm ²

1000W.O.G 不銹鋼牙口三通低平臺球塞閥

3-WAY(L-PORT&T-PORT) BALL VALVE SCREWED END

Mode: TC181

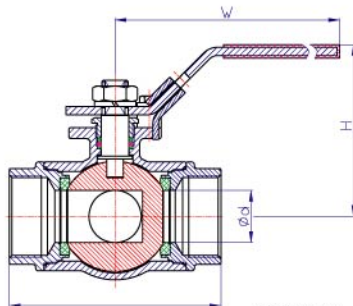

UNIT/mm

SIZE	1/4"	3/8"	1/2"	3/4"	1"	1 1/4"	1 1/2"	2"
d	11.6	12.5	12.5	16	20	25	32	38
L	76	76	76	86	99	117	124	148
H	67	67	67	77	83	88	116	124
W	153	153	153	153	183	188	246	246

部件名稱PART NAME	材質 MATERIAL	
		TC181
閥體 BODY	CF8M	
閥蓋B BONNET-B	CF8M	
鋼球 BALL	CF8M	
球墊 SEAT	PTFE	
軸心 STEM	SUS316	
大薄片B GASKET-B	PTFE	
小薄片 THRUST WASHER	PTFE	
中口 PACKING	PTFE	
軸帽 GLAND	SUS304	
彈簧華司 SPRING WASHER	SUS304	
軸心螺母 STEM NUT	SUS304	
掛鎖裝置 LOCKING DEVICE	SUS304	
把手 HANDLE	SUS304	
把手套 PLASTIC COVER	PLASTIC	
定位銷 STOP PIN	SUS304	
大薄片A GASKET-A	PTFE	
閥蓋A BONNET-A	CF8M	

閥體 (水壓)BODY(WATER)		105 kgf/cm ²
閥座 SEAT	水壓WATER	80 kgf/cm ²
	氣壓AIR	6.0 kgf/cm ²

300W.O.G 不銹鋼牙口閘閥

Mode: TC310

GATE VALVE SCREWED END

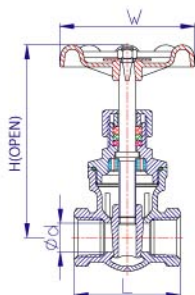

UNIT/mm

SIZE	1/2"	3/4"	1"	1 1/4"	1 1/2"	2"	2 1/2"	3"
d	15	20	25	32	38	50	65	80
L	55	60	65	75	85	95	116	130
H	101	108	115	132	149	175	213	241
W	70	70	80	80	90	100	140	140

部件名稱 PART NAME	材質 MATERIAL
	TC310
閥體 BODY	CF8M
閥蓋 BONNET	CF8M
閥桿 STEM	SUS316
閥瓣 DISC	CF8M
螺母 NUT	SUS304
中口 PACKING	PTFE
手輪 HANDWHEEL	ALUMINUM

閥體 (水壓) BODY(WATER)		32 kgf/cm ²
閥座 SEAT	水壓 WATER	22 kgf/cm ²
	氣壓 AIR	6.0 kgf/cm ²

300W.O.G 不銹鋼牙口球型閥

Mode: TC410

GLOBE VALVE SCREWED END

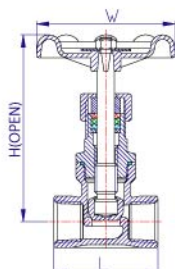

UNIT/mm

SIZE	1/4"	3/8"	1/2"	3/4"	1"	1 1/4"	1 1/2"	2"
L	52	52	52	66	76	86	94	118
H	99	99	99	107	118	150	142	167
W	70	70	70	80	80	90	90	100

部件名稱 PART NAME	材質 MATERIAL
	TC410
閥體 BODY	CF8M
閥蓋 BONNET	CF8M
閥桿 STEM	SUS316
閥瓣 DISC	CF8M
螺母 NUT	SUS304
中口 PACKING	PTFE
手輪 HANDWHEEL	ALUMINUM

閥體 (水壓) BODY (WATER)		32 kgf/cm ²
閥座 SEAT	水壓 WATER	22 kgf/cm ²
	氣壓 AIR	6.0 kgf/cm ²

800W.O.G 不銹鋼牙口Y型過濾器

Mode: TC611

Y STRAINER SCREWED END

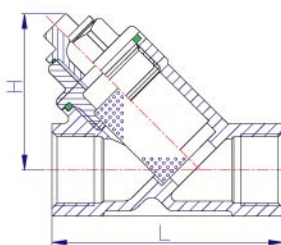

UNIT/mm

SIZE	1/4"	3/8"	1/2"	3/4"	1"	1 1/4"	1 1/2"	2"	2 1/2"	3"
L	65	65	65	80	90	105	120	140	170	195
H	45	45	45	53	68	72	80	97	112	129

部件名稱 PART NAME	材質 MATERIAL
	TC611
閥體 BODY	CF8M
閥蓋 BONNET	CF8M
過濾網 SCREEN	SUS304
塞頭 STOPPER	CF8
大薄片 GASKET	PTFE

閥體 BODY	水壓 WATER	85 kgf/cm ²
	氣壓 AIR	6.0 kgf/cm ²

300W.O.G 不銹鋼牙口逆止閥

Mode: TC511

SWING CHECK VALVE SCREWED END

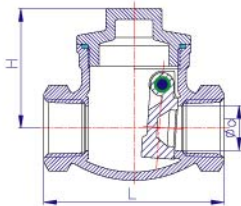

UNIT/mm

SIZE	1/4"	3/8"	1/2"	3/4"	1"	1 1/4"	1 1/2"	2"	2 1/2"	3"
d	10	12	16	20	25	32	40	50	65	80
L	65	65	65	80	89	105	120	139	181	200
H	43	43	43	51	60	66	75	80	99	104

部件名稱 PART NAME	材質 MATERIAL	
	TC510	
閥體 BODY	CF8M	
閥蓋 BONNET	CF8M	
閥瓣 DISC	CF8M	
塞頭 PLUG	SUS316	
大薄片 GASKET	PTFE	

閥體 (水壓) BODY(WATER)		32 kgf/cm ²
閥座 SEAT	水壓 WATER	22 kgf/cm ²
	氣壓 AIR	6.0 kgf/cm ²

JIS-10K 鑄鐵/不銹鋼自動釋氣閥

Mode: TC500, TC501

CAST IRON/STAINLESS STEEL AIR VENT

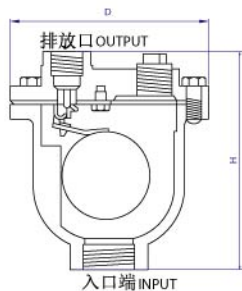

CF8 UNIT/mm

SIZE	1/2"	3/4"	1"
D	133	133	133
H	121	121	121

FC UNIT/mm

SIZE	1/2"	3/4"	1"
D	130	130	130
H	115	115	115

部件名稱 PART NAME	材質 MATERIAL	
	TC500	TC501
閥體 BODY	CAST IRON FC20	CF8
閥蓋 BONNET	CAST IRON FC20	CF8
閥座 SEAT	SUS304	SUS304
桿架 LEVER FRAME	SUS304	SUS304
浮球 FLOAT	SUS304	SUS304
墊片 GASKET	SUS304	SUS304
浮桿 FLOAT ARM	SUS304	SUS304
頂塞 ORITICE BOTTON	SUS304	SUS304

最高使用壓力 WORKING PRESSURE	
80°C 以下之靜流水 STILL WATER(UNDER 80°C)	80°C 以下之脈動水 UNDULATED WATER(UNDER 80°C)
14.0 kgf/cm ²	10.0 kgf/cm ²

自動釋氣閥

Mode: TC1001

AIR VENT

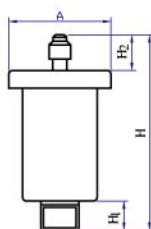

UNIT/mm

SIZE	1/2"	3/4"	1"
A	47	47	47
H	107	108	110
H1	14	15	17
H2	22	22	22

部件名稱 PART NAME	材質 MATERIAL	
	TC1001	
閥體 BODY	CAST BRONZE	
閥蓋 BONNET	CAST BRONZE	
塞頭 PLUG	BRASS	

最高使用壓力 WORKING PRESSURE	
80°C 以下之水 WATER(UNDER 80°C)	
3.5 kgf/cm ²	

JIS-10K/ANSI-150LB 不銹鋼法蘭球塞閥

Mode: TC223, TC224, TC227, TC228

TWO-PIECE BALL VALVE FLANGE END

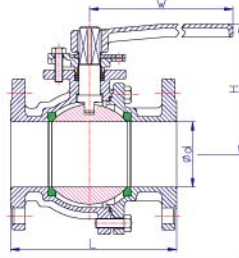

UNIT/mm

SIZE	1/2"	3/4"	1"	1 1/4"	1 1/2"	2"	2 1/2"	3"	4"	5"	6"	8"	10"	12"
d	15	20	25	32	40	50	65	80	100	125	150	200	250	300
L(10K)	110	120	130	140	165	180	190	200	230	300	340	450	530	610
L(150LB)	108	117	127	140	165	178	190	203	229	356	394	457	533	610
H	70	73	77	85	104	114	142	153	166	224	247	305	327	355
W	160	160	160	160	186	186	324	324	324	750	750	1000	1000	1000

部件名稱 PART NAME	材質 MATERIAL			
	TC223	TC227	TC224	TC228
閥體 BODY	CF8	SCS13	CF8M	SCS14
閥蓋 BONNET	CF8	SCS13	CF8M	SCS14
鋼球 BALL	CF8	SCS13	CF8M	SCS14
閥座 SEAT	PTFE			
閥桿 STEM	SUS304		SUS316	
大薄片 GASKET	PTFE			
小薄片 THRUST WASHER	PTFE			
中口 PACKING	PTFE			
牛楠 GLAND	SCS13/CF8			
把手 HANDLE	WCB			
螺栓 BOLT	SUS304			

JIS-10K: TC223, TC224 ANSI-150LB: TC227, TC228

閥體 (水壓) BODY (WATER)	ANSI-150LB	JIS-10K
	32 kgf/cm ²	21 kgf/cm ²
閥座 SEAT	水壓 WATER	16.5 kgf/cm ²
	氣壓 AIR	6.0 kgf/cm ²

JIS-10K/ANSI-150LB 不銹鋼法蘭閘閥

Mode: TC322, TC323, TC325, TC326

GATE VALVE FLANGE END

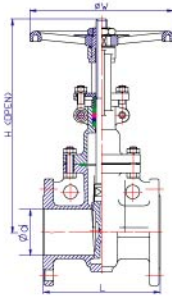

UNIT/mm

SIZE	1/2"	3/4"	1"	1 1/4"	1 1/2"	2"	2 1/2"	3"	4"	5"	6"	8"	10"	12"
d	15	20	25	32	40	50	65	80	100	125	150	200	250	300
L	108	117	127	140	165	178	190	203	229	254	267	292	330	356
H	190	195	234	297	300	331	393	470	545	640	740	910	1097	1285
W	120	120	120	200	200	200	200	250	250	300	300	350	400	400

部件名稱 PART NAME	材質 MATERIAL			
	TC322	TC325	TC323	TC326
閥體 BODY	SCS13	CF8	SCS14	CF8M
閥瓣 DISC	SCS13	CF8	SCS14	CF8M
閥蓋 BONNET	SCS13	CF8	SCS14	CF8M
螺栓/螺母 BOLT/ NUT	SUS304			
牛楠 GLAND	SCS13/CF8			
手輪 HANDWHEEL	FCD			
閥桿 STEM	SUS304		SUS316	
銘牌 NAME PLATE	SUS304			
牛楠襯套 GLAND PACKING	PTFE			
中口 PACKING	PTFE			
大薄片 GASKET	* PTFE /304+GRAPHITE			

JIS-10K: TC322, TC323 ANSI-150LB: TC325, TC326
* 5"UP GASKET: SS304+GRAPHITE

閥體 (水壓) BODY (WATER)	ANSI-150LB	JIS-10K
	32.0 kgf/cm ²	21.5 kgf/cm ²
閥座 SEAT	水壓 WATER	16.5 kgf/cm ²
	氣壓 AIR	6.0 kgf/cm ²

JIS-10K/ANSI-150LB 不銹鋼法蘭球型閥

Mode: T422, TC423, TC425, TC426

GLOBE VALVE FLANGE END

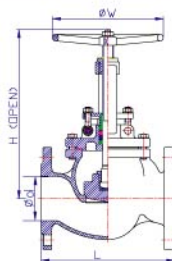

UNIT/mm

SIZE	1/2"	3/4"	1"	1 1/4"	1 1/2"	2"	2 1/2"	3"	4"	5"	6"	8"	10"
d	15	20	25	32	40	50	65	80	100	125	150	200	250
L	108	117	127	140	165	203	216	241	292	356	406	495	622
H	186	186	212	243	246	252	308	327	384	484	547	669	824
W	140	140	140	160	160	200	200	250	250	300	350	350	500

部件名稱 PART NAME	材質 MATERIAL			
	TC422	TC425	TC423	TC426
閥體 BODY	SCS13	CF8	SCS14	CF8M
閥瓣 DISC	SCS13	CF8	SCS14	CF8M
閥桿 STEM	SUS304		SUS316	
大薄片 GASKET	* PTFE/304+GRAPHITE			
閥蓋 BONNET	SCS13	CF8	SCS14	CF8M
中口 PACKING	PTFE			
螺栓/螺母 BOLT/ NUT	SUS304			
牛楠 GLAND	SCS13/CF8			
銘牌 NAME PLATE	SUS304			
手輪 HANDWHEEL	FCD400			

JIS-10K: TC422, TC423 ANSI-150LB: TC425, TC426
* 8"UP GASKET: 304+GRAPHITE

閥體 (水壓) BODY (WATER)	ANSI-150LB	JIS-10K
	32.0 kgf/cm ²	21.5 kgf/cm ²
閥座 SEAT	水壓 WATER	16.5 kgf/cm ²
	氣壓 AIR	6.0 kgf/cm ²

JIS-10K/ANSI-150LB 不銹鋼法蘭Y型過濾器

Mode: TC622, TC623, TC625, TC626

Y STRAINER FLANGE END

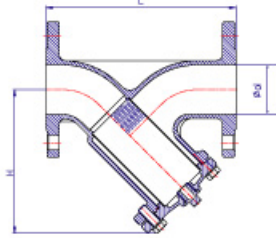

UNIT/mm

SIZE	1/2"	3/4"	1"	1 1/4"	1 1/2"	2"	2 1/2"	3"	4"	5"	6"	8"	10"	12"
d	15	20	25	32	40	50	65	80	100	125	150	200	250	300
L	120	140	150	180	190	210	250	280	340	380	420	500	730	850
H	85	87	114	114	135	155	189	200	232	274	326	397	512	562

部件名稱 PART NAME	材質 MATERIAL			
	TC622	TC623	TC625	TC626
閥體 BODY	SCS13	SCS14	CF8	CF8M
過濾網 SCREEN	SUS304			
大薄片 GASKET	PTFE			
閥蓋 BONNET	SCS13	SCS14	CF8	CF8M
塞頭 STOPPER	SCS14			
螺栓 BOLT	SUS304			

JIS-10K: TC622, TC623
ANSI-150LB: TC625, TC626

閥體 BODY	水壓 WATER	ANSI-150LB	JIS-10K
		32.0 kgf/cm ²	21.5 kgf/cm ²
	氣壓 AIR	6.0 kgf/cm ²	6.0 kgf/cm ²

JIS-10K/ANSI-150LB 不銹鋼法蘭逆止閥

Mode: TC522, TC523, TC525, TC526

SWING CHECK VALVE FLANGE END

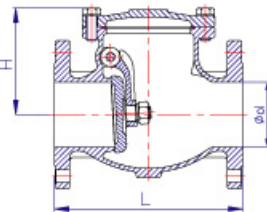

UNIT/mm

SIZE	1/2"	3/4"	1"	1 1/4"	1 1/2"	2"	2 1/2"	3"	4"	5"	6"	8"	10"	12"
d	15	20	25	32	40	50	65	80	100	125	150	200	250	300
L	108	117	127	140	165	203	216	241	292	330	356	495	622	698
H	51	54	64	68	75	98	112	124	161	180	205	236	302	340

部件名稱 PART NAME	材質 MATERIAL			
	TC522	TC525	TC523	TC526
閥體 BODY	SCS13	CF8	SCS14	CF8M
閥蓋 BONNET	SCS13	CF8	SCS14	CF8M
閥瓣 DISC	SCS13	CF8	SCS14	CF8M
大薄片 GASKET	* PTFE/304+GRAPHITE			
塞頭 PLUG	SUS304			
銷 PIN	SUS304			

JIS-10K: TC522, TC523 ANSI-150LB: TC525, TC526
*8"UP GASKET: 304+GRAPHITE

閥體 (水壓) BODY (WATER)	ANSI-150LB	JIS-10K
	32.0 kgf/cm ²	21.5 kgf/cm ²
閥座 SEAT	水壓 WATER	22.0 kgf/cm ² 16.5 kgf/cm ²
	氣壓 AIR	6.0 kgf/cm ² 6.0 kgf/cm ²

JIS-10K/ANSI-150LB 不銹鋼法蘭無聲逆止閥

Mode: TC512, TC513, TC515, TC516

SILENT CHECK VALVE FLANGE END

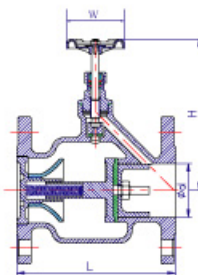

UNIT/mm

SIZE	2"	2 1/2"	3"	4"	5"	6"	8"	10"	12"
d	50	65	80	100	125	150	200	250	300
L	183	200	210	218	255	280	416	560	620
H	160	170	180	190	220	255	290	315	340
W	80	80	80	80	100	100	100	100	100

部件名稱 PART NAME	材質 MATERIAL			
	TC512	TC515	TC513	TC516
閥體 BODY	SCS13	CF8	SCS14	CF8M
閥蓋 BONNET	SCS13	CF8	SCS14	CF8M
彈簧 SPRING	SUS304			
閥瓣 DISC	SCS13	CF8	SCS14	CF8M
螺母/螺栓 NUT/BOLT	SUS304			
大薄片 GASKET	PTFE			
中口 PACKING	PTFE			
閥桿 STEM	SUS304		SUS316	
手輪 HANDWHEEL	ALUMINNUM			
銘牌 NAME PLATE	ALUMINNUM			

JIS-10K: TC512, TC513 ANSI-150LB: TC515, TC516

閥體 (水壓) BODY (WATER)	ANSI-150LB	JIS-10K
	32.0 kgf/cm ²	21.5 kgf/cm ²
閥座 SEAT	水壓 WATER	22.0 kgf/cm ² 16.5 kgf/cm ²
	氣壓 AIR	6.0 kgf/cm ² 6.0 kgf/cm ²

不銹鋼系列

JIS-10K/ANSI-150LB 不銹鋼雙瓣式逆止閥

Mode: TC597, TC598, TC588, TC590

STAINLESS STEEL WAFER TYPE CHECK VALVE

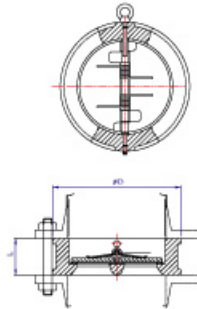

UNIT/mm

SIZE	2"	2 1/2"	3"	4"	5"	6"	8"	10"	12"
D	101	121	131	156	187	217	267	330	375
L	43	46	64	64	70	76	89	114	114

部件名稱 PART NAME	材質 MATERIAL			
	TC597	TC598	TC599	TC590
閥體 BODY	SCS13	SCS14	CF8	CF8M
閥板 PLATE	SCS13	SCS14	CF8	CF8M
閥座 (全內襯) SEAT (Full-Liner)	BUNA-N(NBR), EPDM			
閥桿 STEM	SCS13	SCS14	A276 304	A276 316
定位軸 STOP PIN	SCS13	SCS14	A276 304	A276 316
彈簧 SPRING	SCS13	SCS14	A182 F304	A276 F316

JIS-10K: TC597, TC598
ANSI-150LB: TC599, TC590

最高使用壓力 WORKING PRESSURE		試驗壓力(水壓) TEST PRESSURE(WATER)	
90°C以下之 靜流水 STILL WATER (UNDER 90°C)	90°C以下之 脈動水 UNDULATED WATER (UNDER 90°C)	閥體 BODY	閥座 SEAT
14.0 kgf/cm ²	10.0 kgf/cm ²	21.1 kgf/cm ²	15.0 kgf/cm ²

JIS-10K/ANSI-150LB 對夾式無聲逆止閥

Mode: TC598, TC597

SPRING LOADED WAFER CHECK VALVES

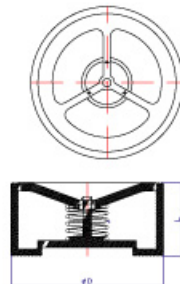

UNIT/mm

SIZE	1/2"	3/4"	1"	1 1/4"	1 1/2"	2"	2 1/2"	3"	4"	5"	6"	8"	10"	12"
D	34	43	50	62	73	88	116	137	170	190	218	273	345	410
L	21	26	28	28	31	40	46	50	60	90	105	140	150	160

部件名稱 PART NAME	材質 MATERIAL	
	TC598F	TC597F
閥體 BODY	1.4408/CF8M	CF8/1.4308
閥瓣 DISC	1.4408/CF8M	CF8/1.4308
閥蓋 BONNET	1.4408/CF8M	CF8/1.4308
彈簧 SPRING	SUS316	SUS304

最高使用壓力 WORKING PRESSURE		試驗壓力(水壓) TEST PRESSURE(WATER)	
90°C以下之 靜流水 STILL WATER (UNDER 90°C)	90°C以下之 脈動水 UNDULATED WATER (UNDER 90°C)	閥體 BODY	閥座 SEAT
14.0 kgf/cm ²	10.0 kgf/cm ²	21.1 kgf/cm ²	15.0 kgf/cm ²

JIS-10K 不銹鋼法蘭拉柄式底閥

Mode: TC522F, TC523F

FOOT VALVE FLANGE END

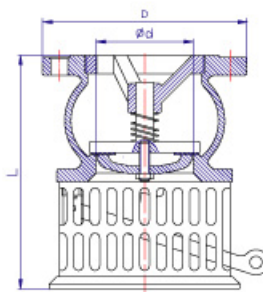

UNIT/mm

SIZE	2"	2 1/2"	3"	4"	5"	6"	8"
d	50	65	80	100	125	150	200
L	190	200	220	240	260	280	390
D	155	175	185	210	250	280	330

部件名稱 PART NAME	材質 MATERIAL	
	TC522F	TC523F
閥體 BODY	SCS13	SCS14
閥蓋 BONNET	SCS13	SCS14
閥瓣 DISC	SCS13	SCS14
彈簧 SPRING	SUS316	
閥瓣座 DISC SEAT	NBR	
壓蓋 GLAND	SCS13	SCS14
螺栓 BOLT	SUS304	
手柄 LEVER HANDLE	SCS13	SCS14
網 SCREEN	SUS304	
板 PLATE	SCS13	SCS14

最高使用壓力 WORKING PRESSURE		試驗壓力(水壓) TEST PRESSURE(WATER)	
常溫之脈動水 UNDULATED WATER (NORMAL TEMPERATURE)		閥體 BODY	閥座 SEAT
10.0 kgf/cm ²		21.1 kgf/cm ²	15.0 kgf/cm ²

JIS-10K/ANSI-150LB

不鏽鋼對夾式 手柄蝶型閥
不鏽鋼對夾式 齒輪蝶型閥

Mode: TC723/TC724
TC723G/TC724G

WAFFER TYPE BUTTERFLY VALVE
(WORM GEAR OPERATION/LEVER OPERATION)

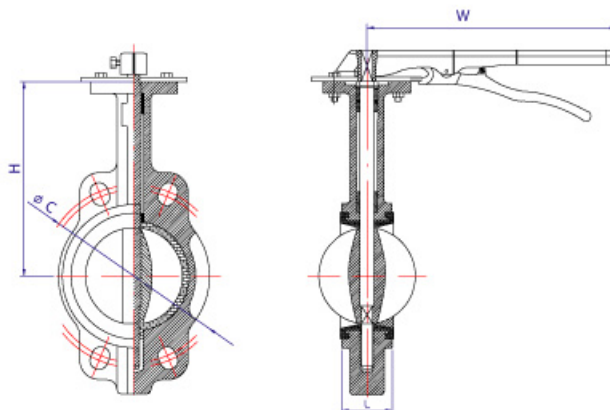

部件名稱 PART NAME	材質 MATERIAL	
	TC723 TC723G	TC724 TC724G
閥體 BODY	CF8	CF8M
閥瓣 DISC	CF8	CF8M
閥座 SEAT	EPDM	
閥桿 STEM	SUS304	SUS316
襯套 BUSHING	PTFE	
O-型圈 O-RING	EPDM	
指示盤 INDICATOR	STAINLESS STEEL	
手柄 LEVER	STAINLESS STEEL	
螺栓 BOLT	STAINLESS STEEL	

把手式蝶型閥LEVER TYPE JIS-10K/ANSI-150LB(CF8):TC723
齒輪式蝶型閥GEAR TYPE JIS-10K/ANSI-150LB(CF8):TC723G
把手式蝶型閥LEVER TYPE JIS-10K/ANSI-150LB(CF8M):TC724
齒輪式蝶型閥GEAR TYPE JIS-10K/ANSI-150LB(CF8M):TC724G

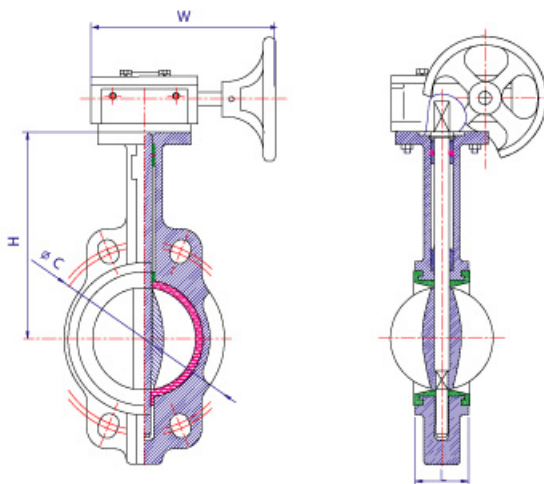

UNIT/mm

SIZE	C(10K)	C(150LB)	L	W	H
2"	120	120.6	42	241	161
2 1/2"	140	139.7	44.7	241	175
3"	150	152.4	45.2	241	181
4"	175	190.5	52	241	200
5"	210	215.9	54.4	270	213
6"	240	241.3	55.8	270	226
8"	290	298.4	60.6		260
10"	355	361.9	65.6		292
12"	400	431.8	76.9		337

最高使用壓力 WORKING PRESSURE	試驗壓力 TEST PRESSURE	
90℃以下之靜流水 STILL WATER(UNDER 90℃)	閥體 BODY	閥座 SEAT
10.0 kgf/cm ²	15.0 kgf/cm ²	11.0 kgf/cm ²

JIS-10K/ANSI-150LB

不鏽鋼對夾式 手柄蝶型閥
不鏽鋼對夾式 齒輪蝶型閥

Mode: TC723J/TC724J
TC723JG/TC724JG

WAFER TYPE BUTTERFLY VALVE
(WORM GEAR OPERATION/LEVER OPERATION)

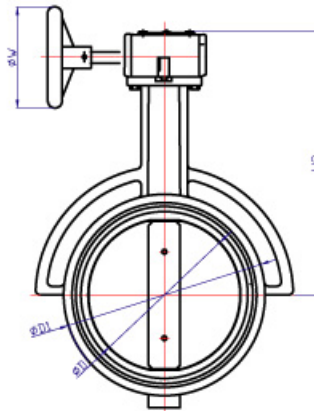
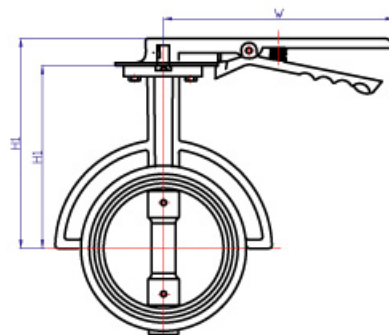
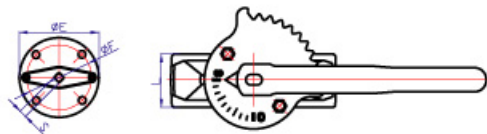

NO.	PART NAME	MATERIAL	
		TC723J TC723GJ	TC724J TC724GJ
1	BODY	CF8	CF8M
2	DISC	CF8	CF8M
3	STEM	SUS304	SUS316
4	SEAT	PTFE / TFM1600	
5	GLAND	SUS316	
6	PACKING	PTFE	
7	PACKING	GRAPHITE	
8	PACKING	PTFE	
9	TAPER PIN	SUS304	
10	SPACER BUSH	3196	
11	BOLT	SUS304	

把手式蝶型閥LEVER TYPE JIS-10K/ANSI-150LB(CF8) TC723J
齒輪式蝶型閥GEAR TYPE JIS-10K/ANSI-150LB(CF8) TC723GJ
把手式蝶型閥LEVER TYPE JIS-10K/ANSI-150LB(CF8M): TC724J
齒輪式蝶型閥GEAR TYPE JIS-10K/ANSI-150LB(CF8M) TC724GJ

UNIT/mm

SIZE	L	H1	H2	H3	□S	□S	ØS	D	D1	W	W1	E	F
2"	43	140	168	203	11	9.0	12.7	43	90	250	197	92	70
2 1/2"	46	145	173	208	11	9.0	12.7	59	118	250	197	92	70
3"	46	155	183	218	11	9.0	12.7	72	130	250	197	92	70
4"	53	178	206	241	14	12.5	16	92	154	250	197	92	70
5"	56	188	216	251	14	12.5	16	114	195	250	197	92	70
6"	56	210	240	273	14	15	19	147	215	345	197	92	70
8"	60	240	270	303	19	15	25	196	264	345	197	92	70
10"	68	291		370	22	16	30	246	330		297	120	102
12"	78	310		389	22	20	32	294	374		297	120	102
14"	78	323		402	27	23	32	320	415		297	130	125
16"	102	360		440	36		40	380	480		297	130	140
18"	114	417		498	36		45	430	534		297	150	140
20"	127	443		529	46		60	468	586		350	180	165
24"	154	528		618	46		60	578	696		350	180	165

JIS-16K 不銹鋼法蘭閘閥

Mode: TC322K, TC323K

GATE VALVE FLANGE END

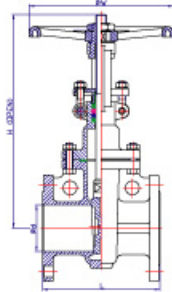

UNIT/mm

SIZE	1/2"	3/4"	1"	1 1/4"	1 1/2"	2"	2 1/2"	3"	4"	5"	6"	8"	10"	12"
d	15	20	25	32	40	50	65	80	100	125	150	200	250	300
L	108	117	127	140	165	178	190	203	229	254	267	292	330	356
H	190	195	234	297	300	331	393	470	545	640	740	910	1097	1285
W	120	120	120	200	200	200	200	250	250	300	300	350	400	400

部件名稱 PART NAME	材質 MATERIAL	
	TC322K	TC323K
閥體 BODY	SCS13	SCS14
閥蓋 DISC	SCS13	SCS14
閥蓋螺栓 BONNET BOLT	SUS304	
閥蓋螺母 BONNET NUT	SUS304	
閥蓋 BONNET	SCS13	SCS14
撞栓 HINGE PIN	SUS304	
單眼螺栓 EYE BOLT	SUS304	
牛橋 GLAND	SCS13	
單眼螺母 EYE NUT	SUS304	
手輪 HANDWHEEL	FCD	
螺母 NUT	BRONZE	
閥桿 STEM	SUS304	SUS316
銘牌 NAME PLATE	SUS304	
彈簧 SPRING	BRONZE	
軸套 YOKE SLEEVE	BRONZE	
彈簧華司 SPRING WASHERS	SUS304	
牛橋襯套 GLAND PACKING	PTFE	
中口 PACKING	PTFE	
大薄片 GASKET	* PTFE / 304+GRAPHITE	

* 5"UP GASKET: S5304+GRAPHITE

閥體 (水壓) BODY(WATER)	4.1 MPa
	42kg/cm ²
閥座 SEAT	水壓 WATER 3.0 MPa
	氣壓 AIR 0.6 MPa
	30.5kg/cm ²
	6kg/cm ²

JIS-16K 不銹鋼法蘭球型閥

Mode: T422K, TC423K

GLOBE VALVE FLANGE END

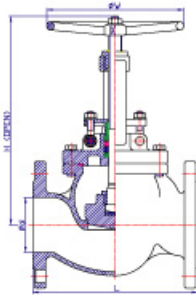

UNIT/mm

SIZE	1/2"	3/4"	1"	1 1/4"	1 1/2"	2"	2 1/2"	3"	4"	5"	6"	8"	10"
d	15	20	25	32	40	50	65	80	100	125	150	200	250
L	108	117	127	140	165	203	216	241	292	356	406	495	622
H	186	186	212	243	246	252	308	327	384	484	547	669	824
W	140	140	140	160	160	200	200	250	250	300	350	350	500

部件名稱 PART NAME	材質 MATERIAL	
	TC322K	TC323K
閥體 BODY	SCS13	SCS14
閥瓣 DISC	SCS13	SCS14
閥瓣蓋 DISC COVER	SCS13	SCS14
閥桿 STEM	SUS304	SUS316
大薄片 GASKET	* PTFE / 304+GRAPHITE	
閥蓋 BONNET	SCS13	SCS14
中口 PACKING	PTFE	
螺栓 BOLT	SUS304	
撞栓 HINGE PIN	SUS304	
襯套 SLEEVE	PTFE	
牛橋 GLAND	SCS13	
螺母 NUT	SUS304	
單眼螺栓 EYE BOLT	SUS304	
軸套 YOKE SLEEVE	BRONZE	
銘牌 NAME PLATE	SUS304	
螺母 NUT	SUS304	
手輪 HANDWHEEL	FCD400	
彈簧華司 SPRING WASHERS	SUS304	

* 8"UP GASKET: 304+GRAPHITE

閥體 (水壓) BODY(WATER)	4.1 MPa
	42kg/cm ²
閥座 SEAT	水壓 WATER 3.0 MPa
	氣壓 AIR 0.6 MPa
	30.5kg/cm ²
	6kg/cm ²

JIS-16K 不銹鋼法蘭Y型過濾器

Mode: TC622K, TC623K

Y STRAINER FLANGE END

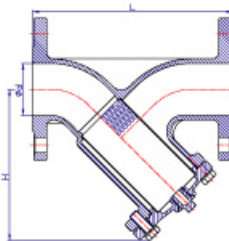

UNIT/mm

SIZE	1/2"	3/4"	1"	1 1/4"	1 1/2"	2"	2 1/2"	3"	4"	5"	6"	8"	10"	12"
d	15	20	25	32	40	50	65	80	100	125	150	200	250	300
L	120	140	150	180	190	210	250	280	340	380	420	500	730	850
H	85	87	114	114	135	155	189	200	232	274	326	397	512	562

部件名稱 PART NAME	材質 MATERIAL	
	TC622k	TC625k
閥體 BODY	SCS13	SCS14
過濾網 SCREEN	SUS304	SUS316
大薄片 GASKET	PTFE	
閥蓋 BONNET	SCS13	SCS14
大薄片 GASKET	PTFE	
塞頭 STOPPER	SCS14	
彈簧華司 SPRING WASHERS	SUS304	
閥蓋螺栓 BONNET BOLT	SUS304	

閥體 BODY	水壓 WATER 4.1 MPa
	氣壓 AIR 0.6 MPa
	42kg/cm ²
	6kg/cm ²

JIS-16K 不銹鋼法蘭逆止閥

Mode: TC522K, TC523K

SWING CHECK VALVE FLANGE END

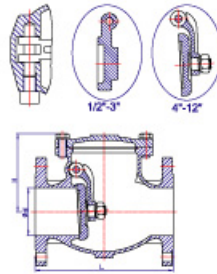

UNIT/mm

SIZE	1/2"	3/4"	1"	1 1/4"	1 1/2"	2"	2 1/2"	3"	4"	5"	6"	8"	10"	12"
d	15	20	25	32	40	50	65	80	100	125	150	200	250	300
L	108	117	127	140	165	203	216	241	292	330	356	495	622	698
H	51	54	64	68	75	98	112	124	161	180	205	236	302	340

部件名稱 PART NAME	材質 MATERIAL	
	TC522K	TC523K
閥體 BODY	SCS13	SCS14
閥瓣 DISC	SCS13	SCS14
螺母 NUT	SUS304	
搖臂 ARM HINGE	SCS13	SCS14
橫栓 HINGE PIN	SUS304	SUS316
大薄片 GASKET	* PTFE / 304+GRAPHITE	
閥蓋 BONNET	SCS13	SCS14
彈簧華司 SPRING WASHERS	SUS304	
閥蓋螺絲 BONNET BOLT	SUS304	
螺絲 BOLT	SUS304	

*8"UP GASKET:304+GRAPHITE

閥體 (水壓) BODY(WATER)	4.1 MPa
	42kg/cm ²
閥座 SEAT	水壓WATER
	氣壓AIR
水壓WATER	3.0 MPa
氣壓AIR	0.6 MPa
	30.5kg/cm ²
	6kg/cm ²

JIS-16K 不銹鋼法蘭無聲逆止閥

Mode: TC512K, TC513K

SILENT CHECK VALVE FLANGE END

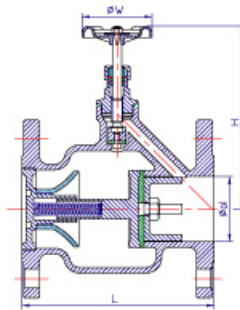

UNIT/mm

SIZE	2"	2 1/2"	3"	4"	5"	6"	8"	10"	12"
d	50	65	80	100	125	150	200	250	300
L	183	200	210	218	255	280	416	560	620
H	160	170	180	190	220	255	290	315	340
W	80	80	80	80	100	100	100	100	100

部件名稱 PART NAME	材質 MATERIAL	
	TC512K	TC513K
閥體 BODY	SCS13	SCS14
閥蓋 BONNET	SCS13	SCS14
彈簧 SPRING	SUS304	
閥瓣 DISC	SCS13	SCS14
閥瓣墊片 DISC GASKET	PTFE	
閥蓋墊片 DISC GASKET	SCS13	SCS14
螺母 NUT	SUS304	
螺絲 BOLT	SUS304	
閥瓣墊片 DISC GASKET	PTFE	
閥瓣 DISC	SCS13	SCS14
大薄片 GASKET	PTFE	
閥蓋 BONNET	SCS13	SCS14
螺母 NUT	SUS304	
大薄片 GASKET	SUS304	
中口 PACKING	PTFE	
套筒 GASKET	SUS304	
閥桿 STEM	SUS304	SUS316
手輪 HANDWHEEL	ALUMINUM	
銘牌 NAMEPLATE	ALUMINUM	
軸心螺母 STEM NUT	SUS304	

閥體 (水壓) BODY(WATER)	4.1 MPa
	42kg/cm ²
閥座 SEAT	水壓WATER
	氣壓AIR
水壓WATER	3.0 MPa
氣壓AIR	0.6 MPa
	30.5kg/cm ²
	6kg/cm ²

JIS-16K 不銹鋼法蘭拉柄式底閥

Mode: TC522K, TC523K

FOOT VALVE FLANGE END

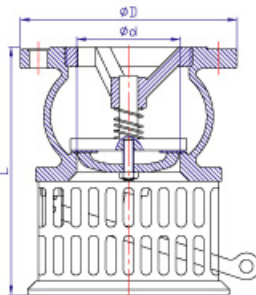

UNIT/mm

SIZE	2"	2 1/2"	3"	4"	5"	6"	8"
d	50	65	80	100	125	150	200
L	190	200	220	240	260	280	390
D	155	175	200	225	270	305	350

部件名稱 PART NAME	材質 MATERIAL	
	TC522K	TC523K
閥體 BODY	SCS13	SCS14
閥蓋 BONNET	SCS13	SCS14
閥瓣 DISC	SCS13	SCS14
彈簧 SPRING	SUS316	
閥瓣座 DISC SEAT	NBR	
壓蓋 GLAND	SCS13	SCS14
螺絲 BOLT	SUS304	
手柄 LEVER HANDLE	SCS13	SCS14
網 SCREEN	SUS304	
板 PLATE	SCS13	SCS14

閥體 (水壓) BODY(WATER)	4.1 MPa
	42kg/cm ²
閥座 SEAT	水壓WATER
	氣壓AIR
水壓WATER	3.0 MPa
氣壓AIR	0.6 MPa
	30.5kg/cm ²
	6kg/cm ²

JIS-10K/ANSI-150LB

鋁合金對夾式 把手蝶型閥
鋁合金對夾式 齒輪蝶型閥

Mode: TC731A

ALUMINUM DIECAST ALLOY BUTTERFLY VALVE

Wafer type body, Renewable seat, Center driver disc.

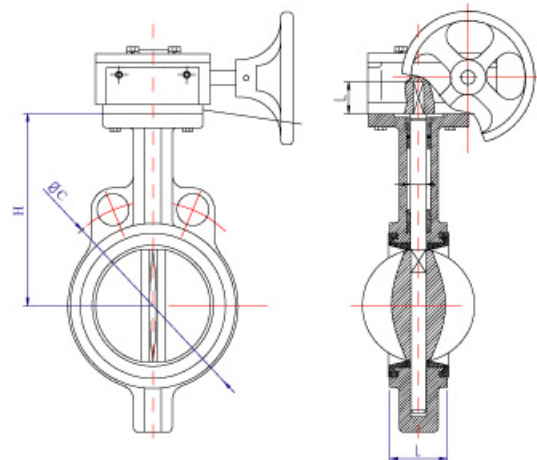
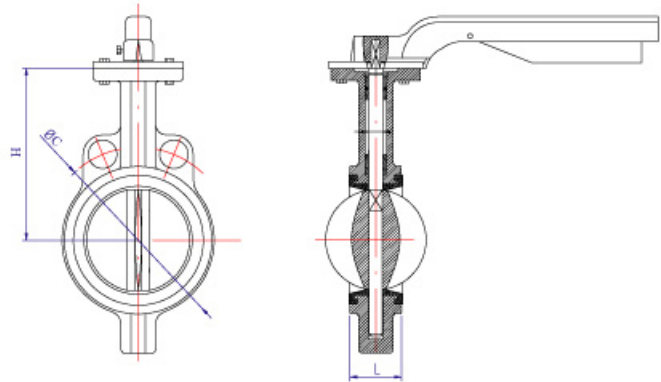

部件名稱 PART NAME	材質 MATERIAL
閥體 BODY	ALUMINUM DIECAST ALLOY
閥瓣 DISC	SUS304
閥座 SEAT	EPDM
閥桿 STEM	SUS410
手柄 LEVER	ALUMINUM DIECAST ALLOY
齒輪箱 GEAR	ALUMINUM DIECAST ALLOY

UNIT/mm

SIZE	C(10K)	C(1150LB)	L	H
2"	120	120.6	42	140
2 1/2"	140	139.7	45	150
3"	150	152.4	45	155
4"	175	190.5	52	167
5"	210	215.9	54	187
6"	240	241.3	55.5	202
8"	290	298.4	60.5	230
10"	355	361.9	66	280
12"	400	431.8	77	310

最高使用壓力 WORKING PRESSURE	試驗壓力 TEST PRESSURE	
90°C 以下之靜流水 STILL WATER (UNDER 90°C)	閥體 BODY	閥座 SEAT
10.0 kgf/cm ²	15.0 kgf/cm ²	11.0 kgf/cm ²

鋁合金系列



臺灣總公司

TAIWAN COMPANY

地址：嘉義縣民雄工業區中山路40號
ADD:NO.40 Zhongshan Road,Ming Shung
Industrial Distric,Chiayi,Taiwan,R.O.C
電話 TEL: 05-2215962 2215963
傳真 FAX: 05-2214361 2215965
E-mail: sowlong3@hotmail.com
<http://www.sowlong.com.tw>

中國公司

CHINA COMPANY

地址：中山市三鄉鎮大佈平埔工業區
ADD: Dabu Pingpu Industrial Zone Sanxiang
Zhongshan City Guangdong Province.
電話 TEL: 0760-86330198 86330199
傳真 FAX: 0760-86336311
E-mail: sales@longcheng-valves.com
<http://www.longcheng-valves.com>

